

**Engine nacelle front view**

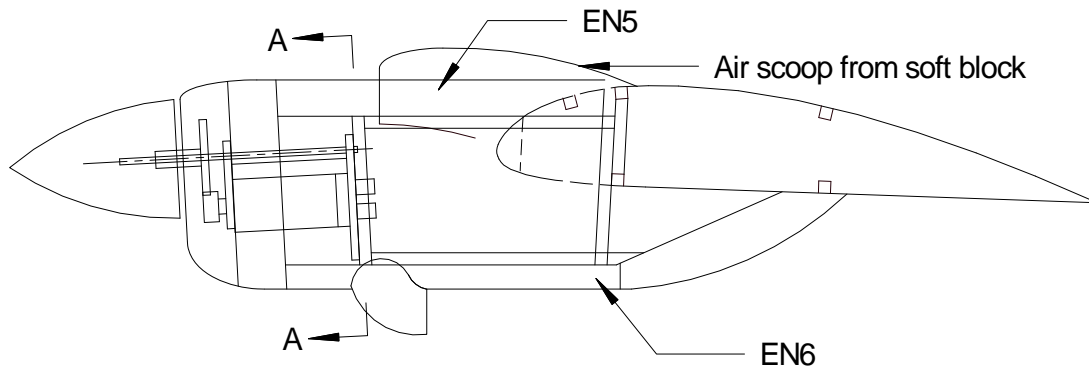

**Engine nacelle side view**

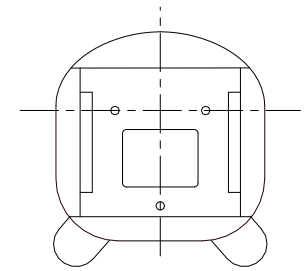

**Section A-A**

▲ Balance at this point

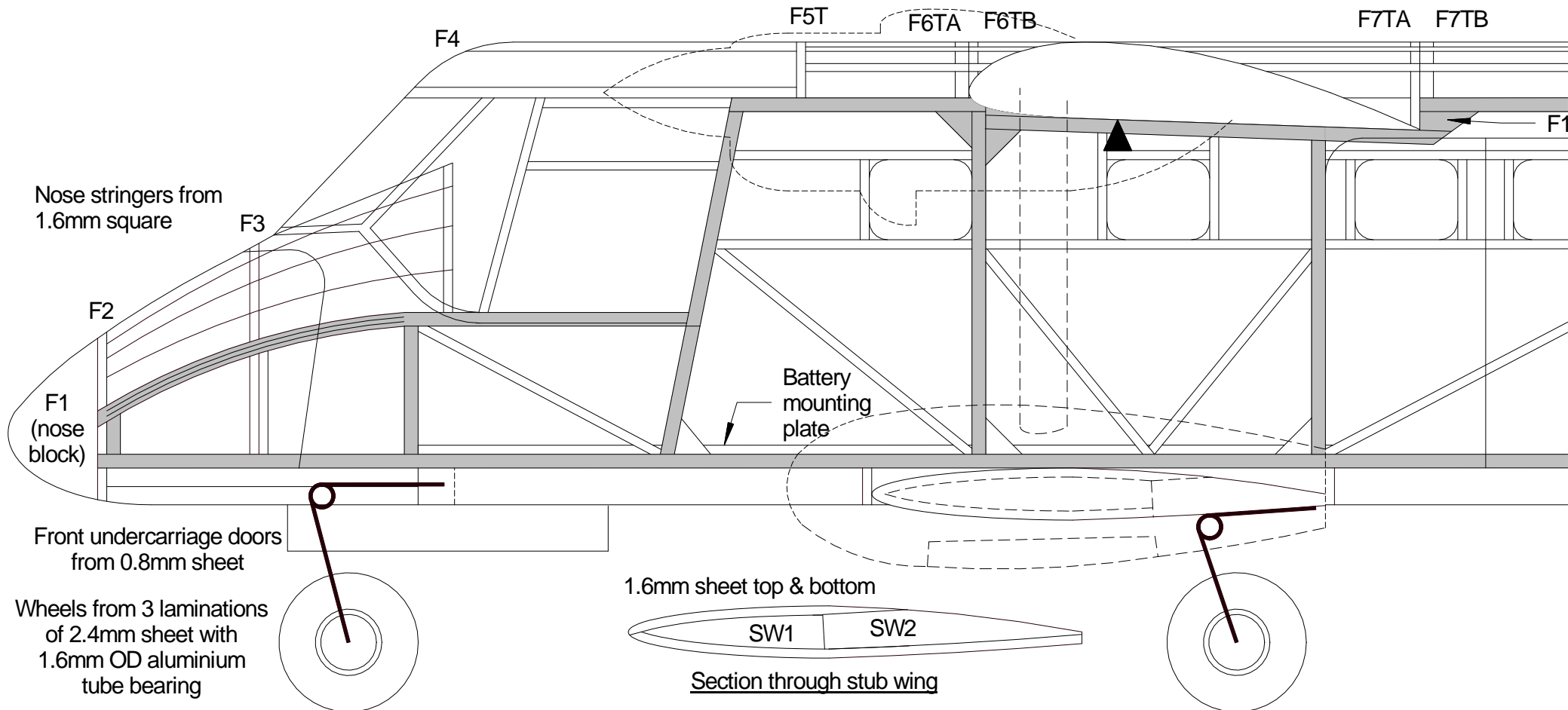

**Section through stub wing**

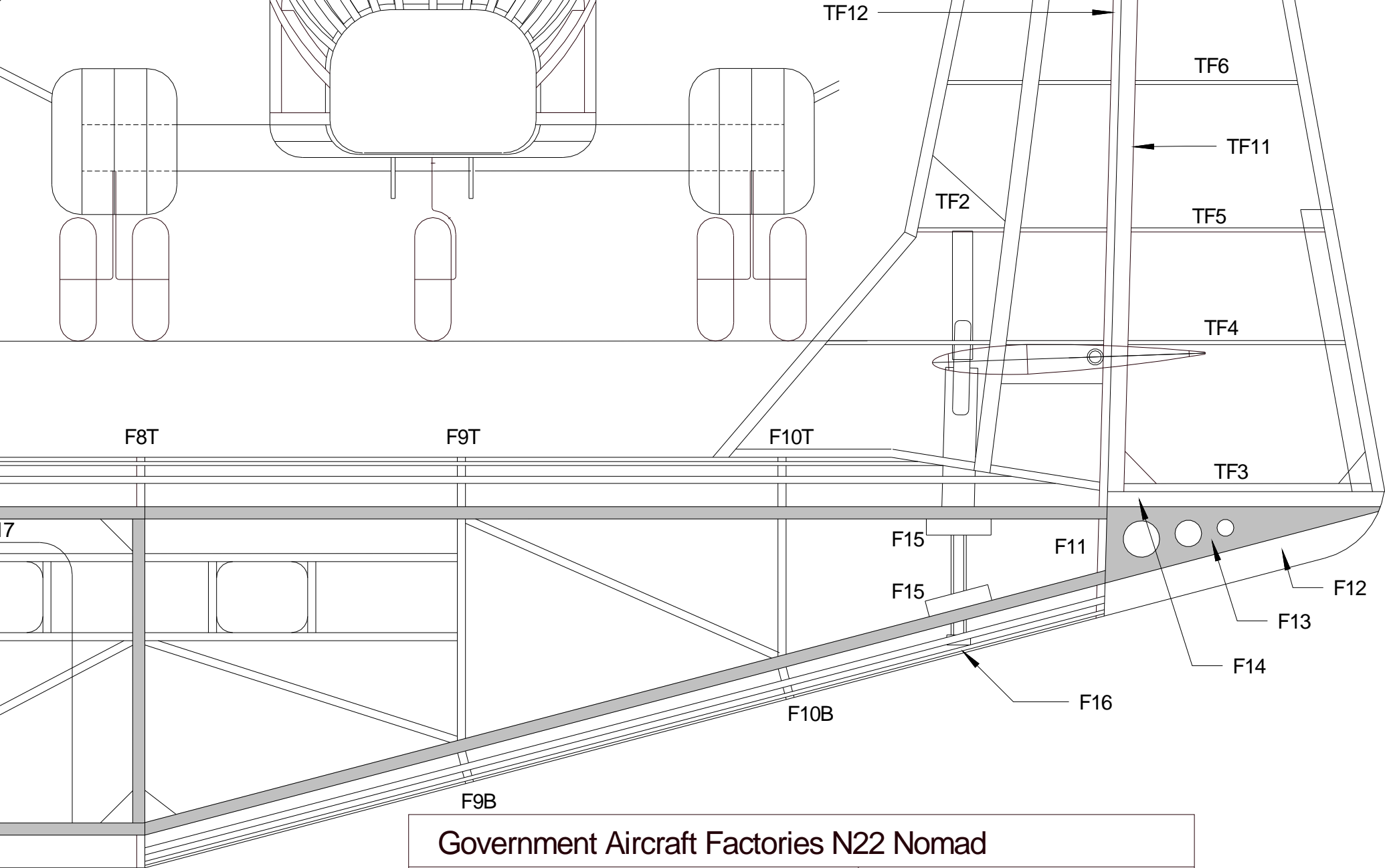

## Government Aircraft Factories N22 Nomad

Dimensions:	Prototype:	Model:
Span:	14.5 m	711mm (28.0 in)
Length:	12.57 m	547 mm (21.5 in)
Wing area:	30.2 m <sup>2</sup>	5.12 dm <sup>2</sup> (79.4 in <sup>2</sup> )
T/O Weight:	3,856 kg	72 g (2.6 oz)
Scale:		1 : 23.1

© D Buckmaster 2001

Designed by Derek Buckmaster

Website:  
<http://members.nbci.com/dbdesignbureau>

e-mail:  
[dbdesign@crosswinds.net](mailto:dbdesign@crosswinds.net)

Leading edge 3.2mm

All spars 1.6mm square

R3

R3

R3

R2

R1

W3

R1

W10

W3

R1

Trailing edge 3.2mm x 8mm

Cut away leading edge after sanding to shape

R3

R3

R3

R2

R1

W3

R1

W10

W3

R1

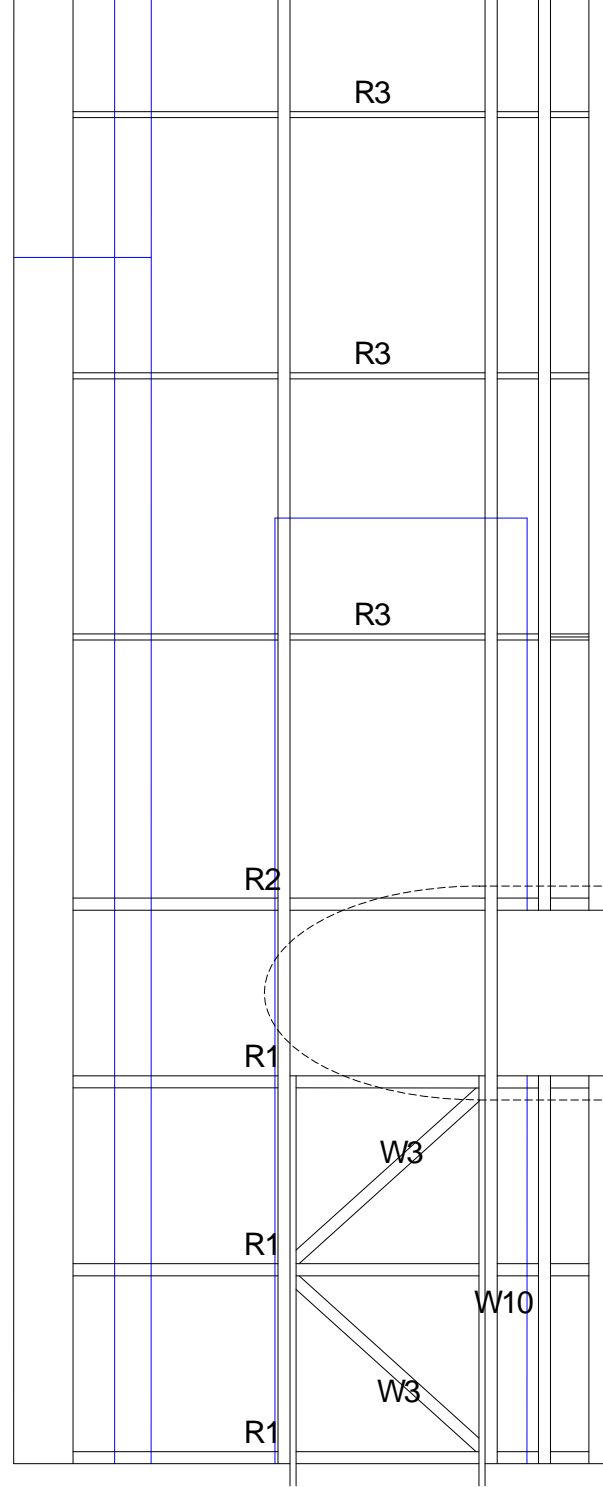
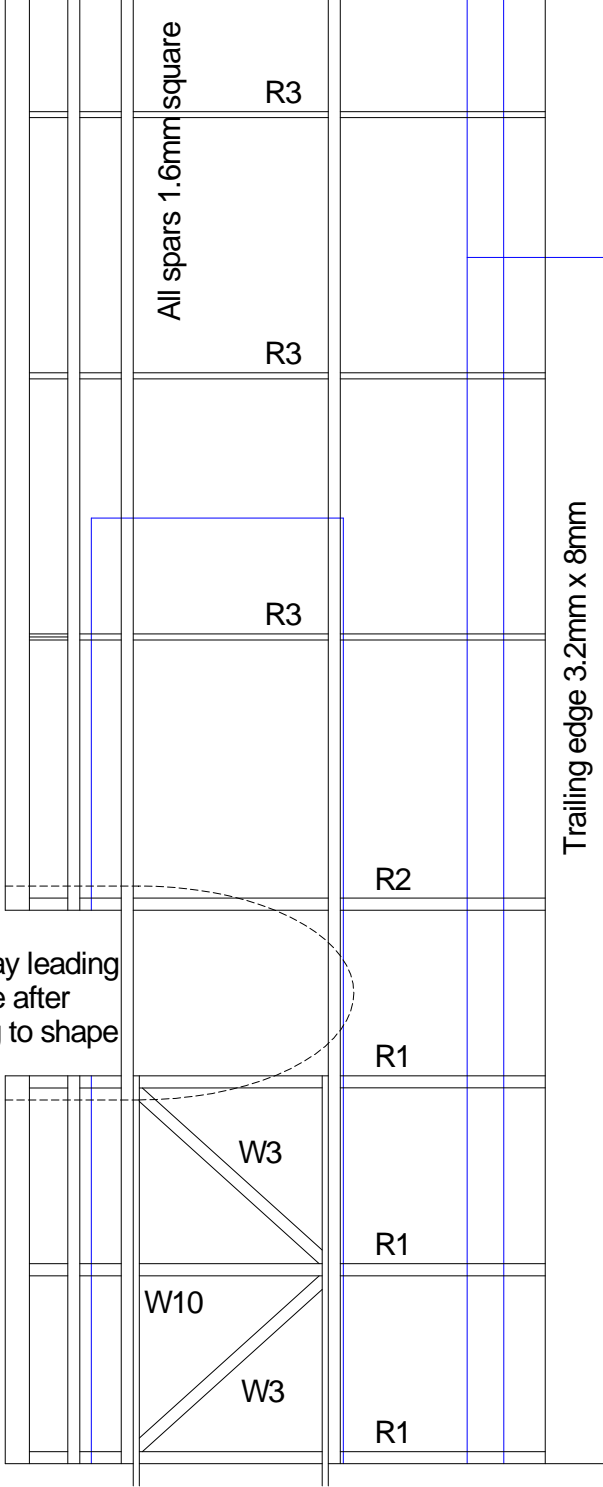

Tailplane incidence adjustment:

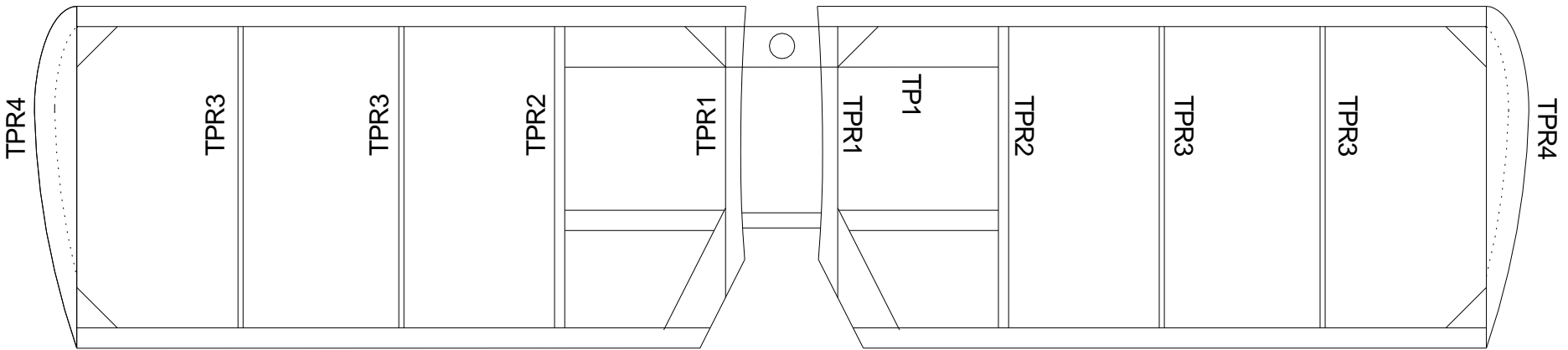
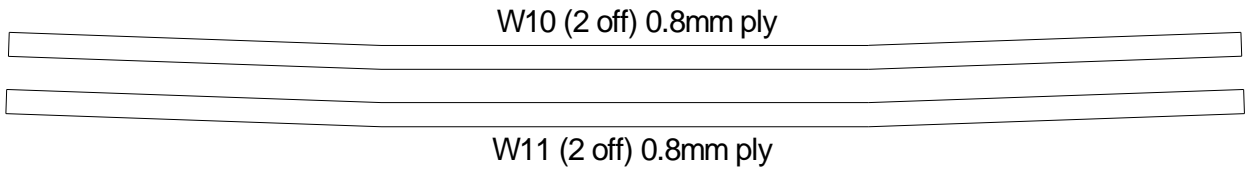
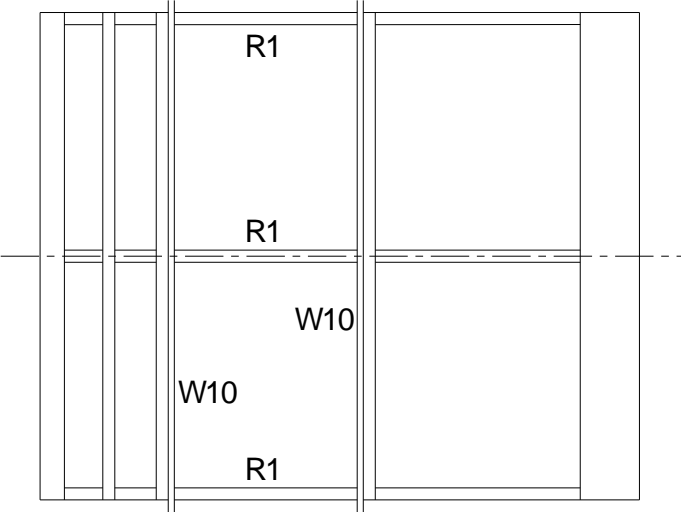
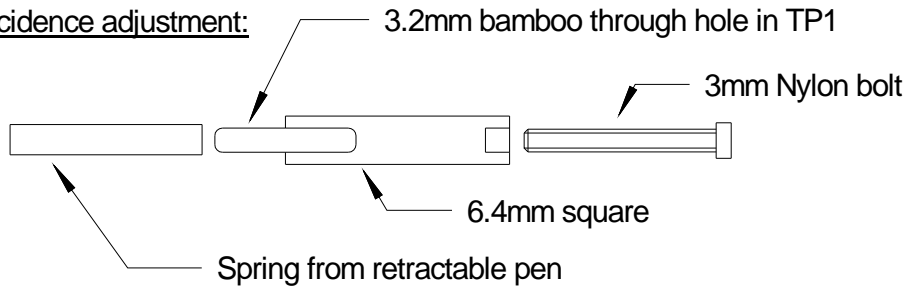

F17 (2 off)  
2.4 mm

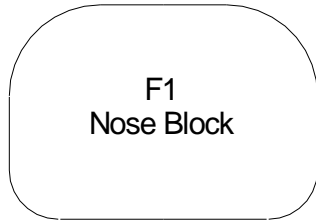

F1  
Nose Block

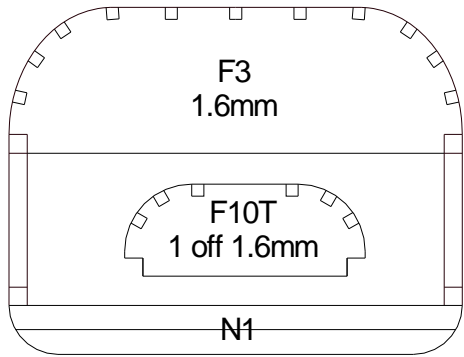

F3  
1.6mm

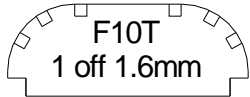

F10T  
1 off 1.6mm

N1

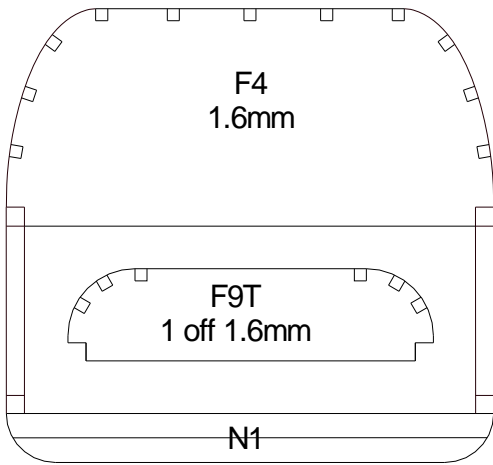

F4  
1.6mm

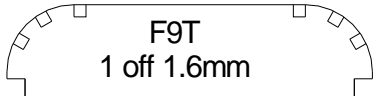

F9T  
1 off 1.6mm

N1

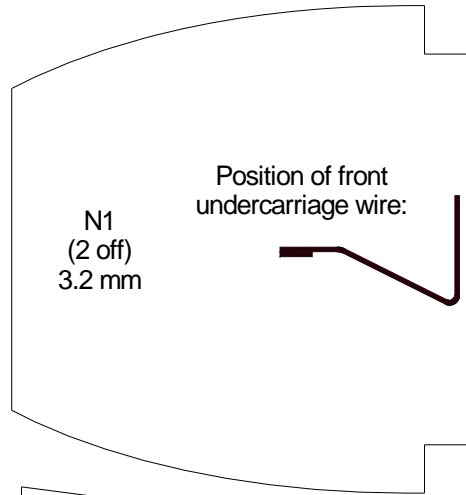

N1  
(2 off)  
3.2 mm

Position of front  
undercarriage wire:

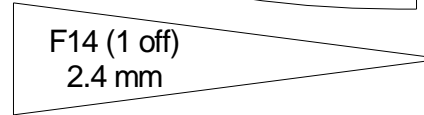

F14 (1 off)  
2.4 mm

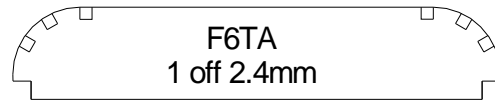

F6TA  
1 off 2.4mm

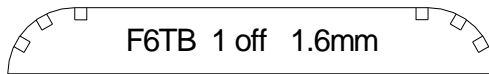

F6TB 1 off 1.6mm

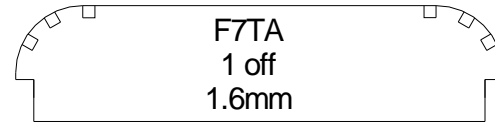

F7TA  
1 off  
1.6mm



F7TB  
1 off  
2.4mm

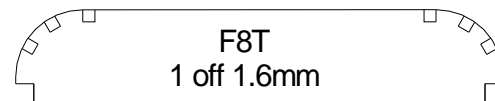

F8T  
1 off 1.6mm

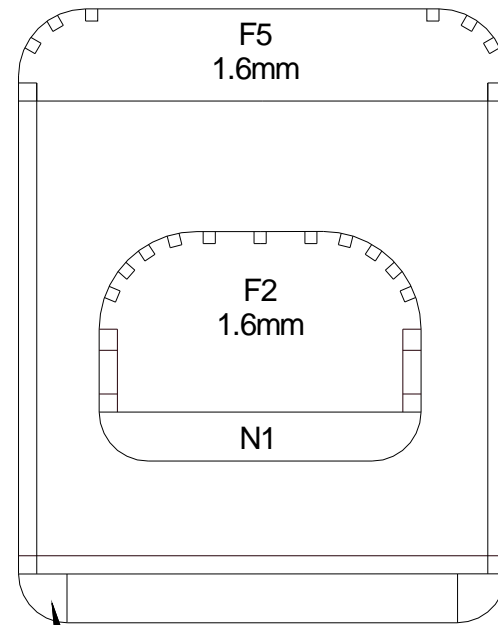

F5  
1.6mm

F2  
1.6mm

N1

Soft 6.4 mm square

F12  
2 off 2.4mm

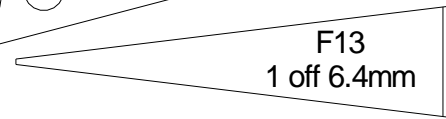
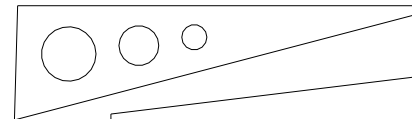

F13  
1 off 6.4mm



F8B



F9B

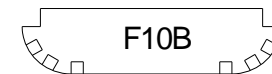

F10B

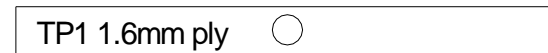

TP1 1.6mm ply

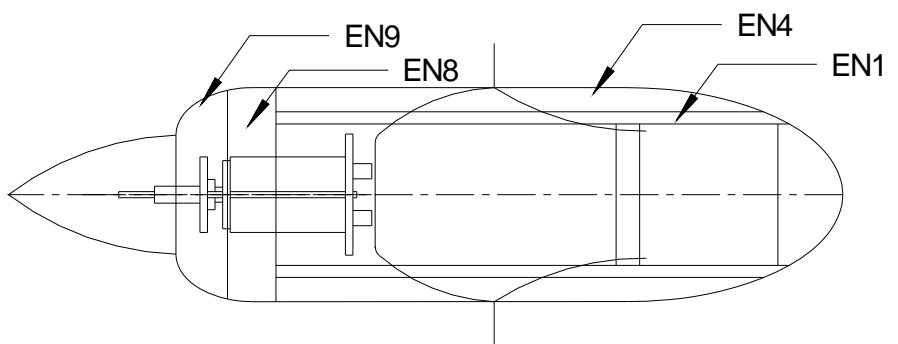
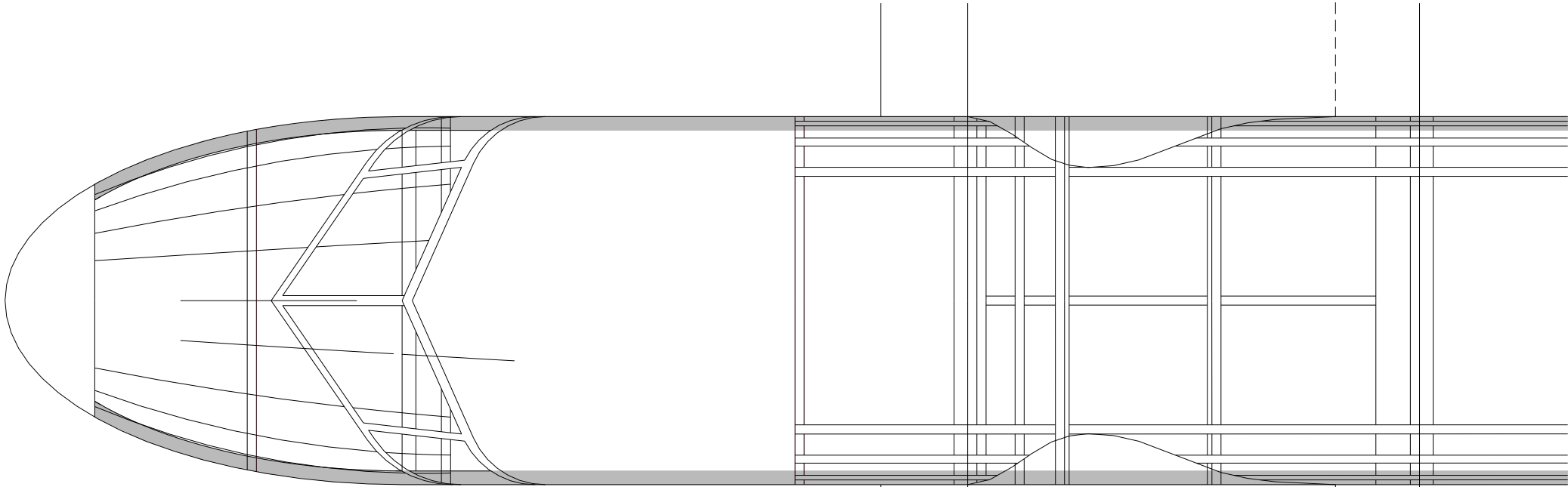

**Engine nacelle top view**

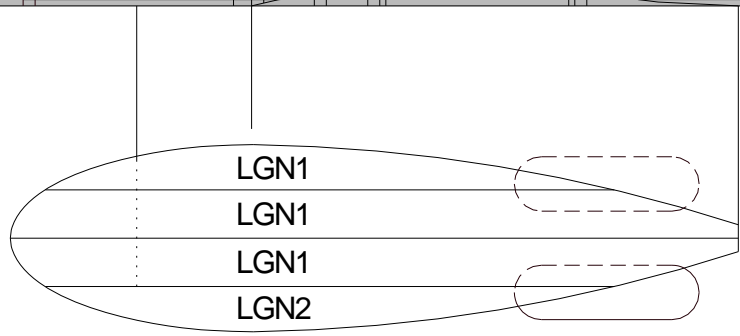

6.4mm dihedral under each wing tip

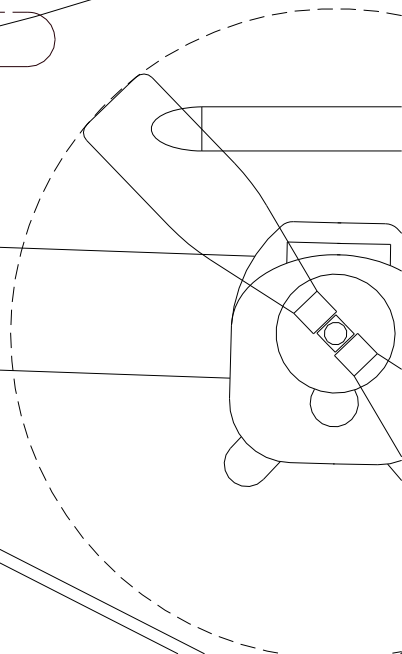

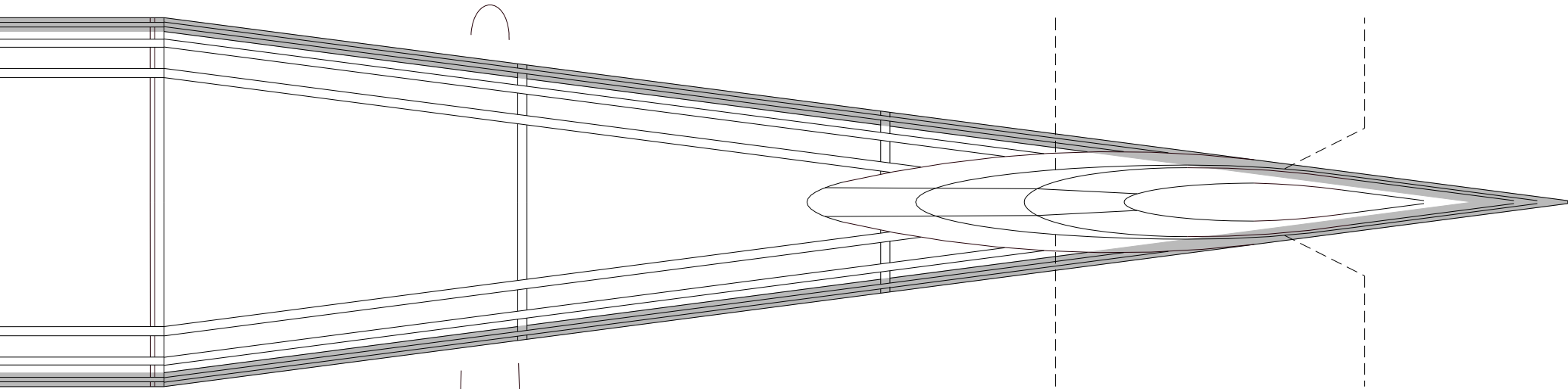

**Metric conversions:**

0.8mm	1/32"
1.6mm	1/16"
2.4mm	3/32"
3.2mm	1/8"
4.8mm	3/16"
6.4mm	1/4"

**Fuselage construction:**

- Main side frames (shaded in gray) from 2.4mm square
- Diagonal bracing and window frames from 2.4 x 1.6mm strip
- Stringers on nose and rounded corners from 1.6mm square
- Top and bottom formers from 1.6mm sheet

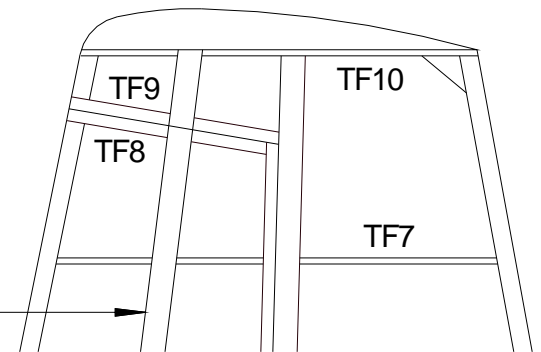
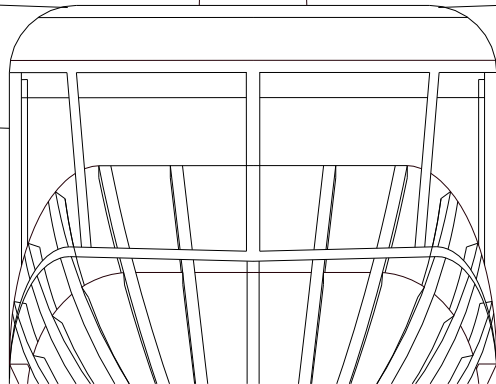
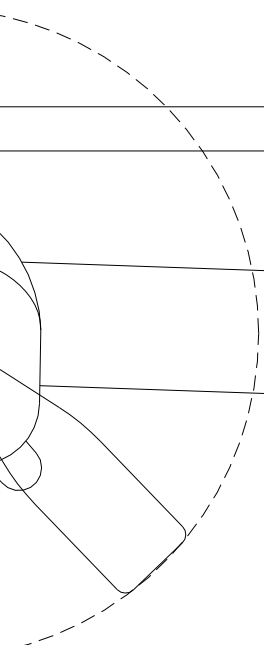

1.6 x 3.2 mm

Lift struts from hard 2.4mm sheet (2 off)

Wing construction:

- Pin down trailing edge and position lower spars
- Glue ribs in place
- Add leading edge and upper spars
- Shape leading edge and cut out section for engine nacelles

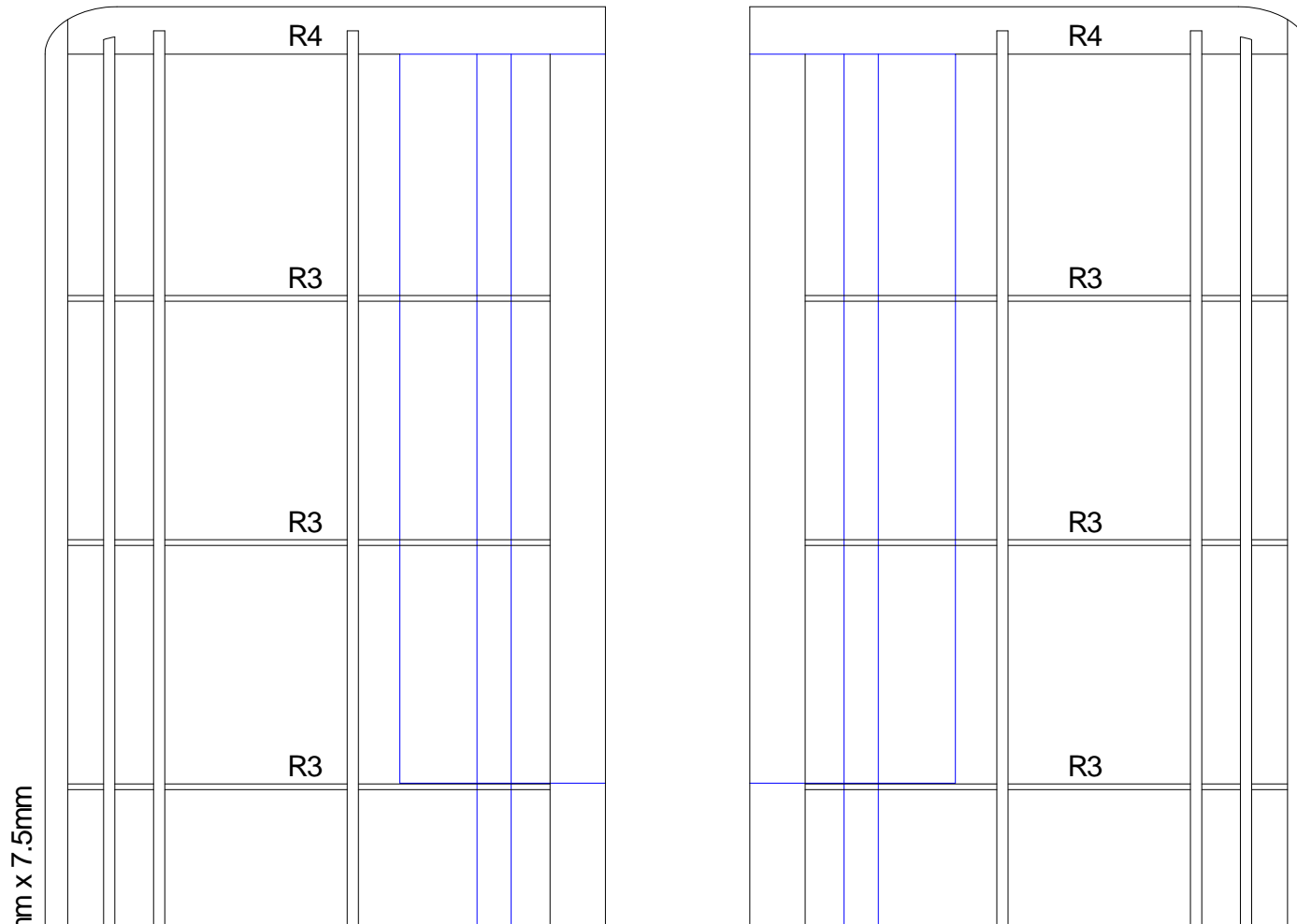



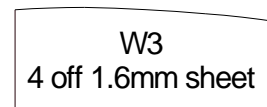
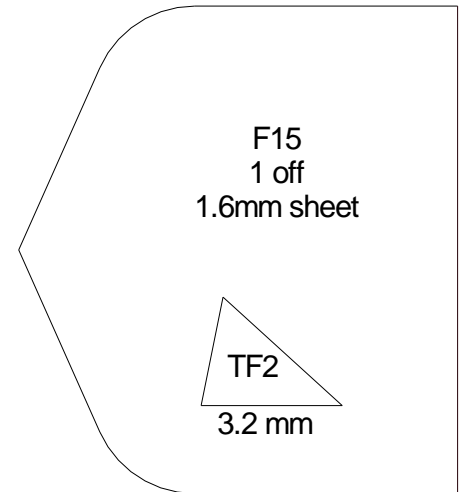
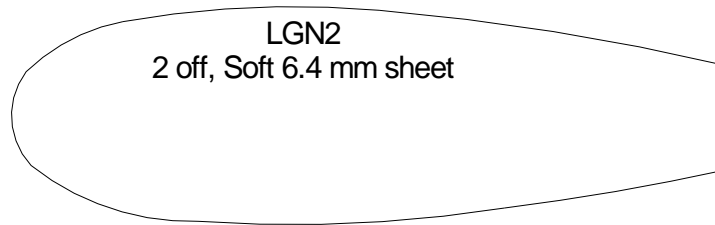
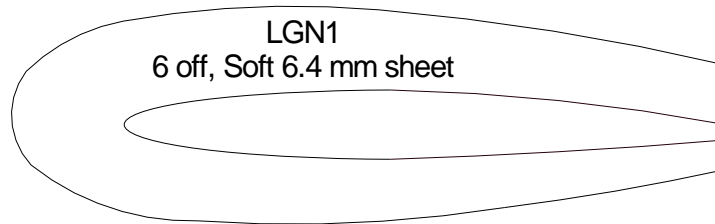
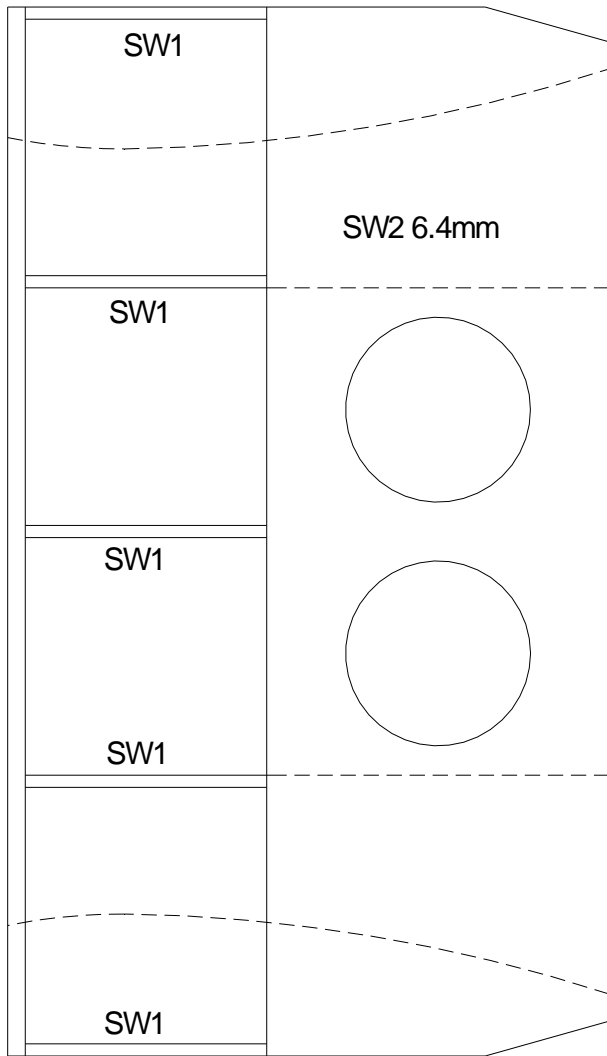

Instrument panel (glue to F4)

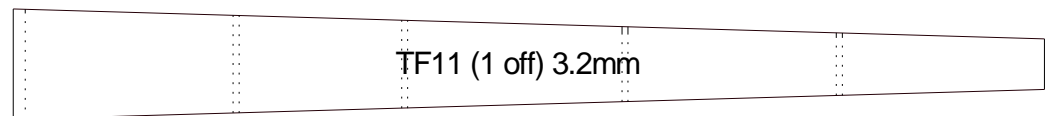
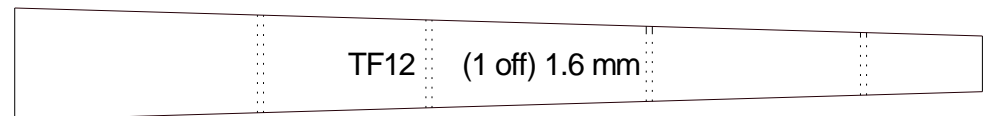
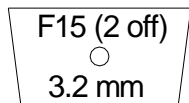
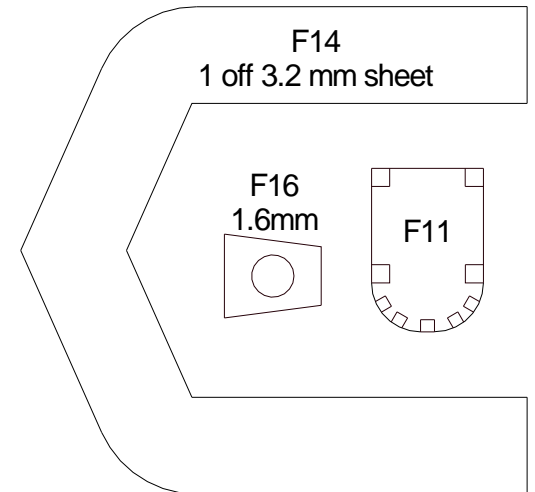
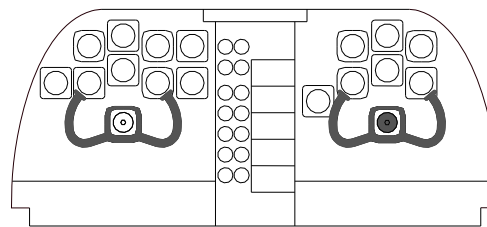

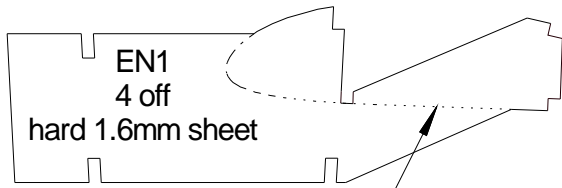

Location of EN4

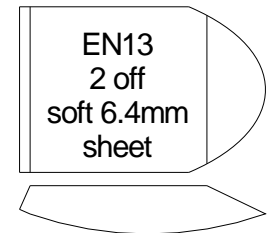
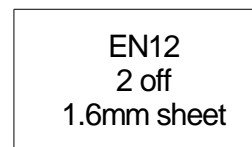
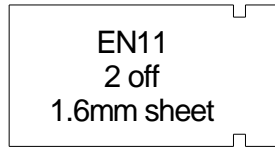
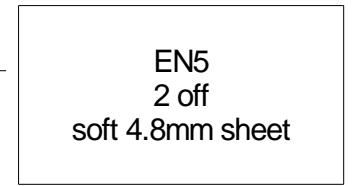
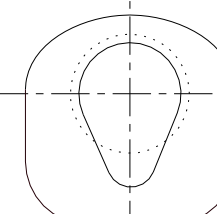
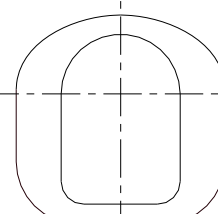
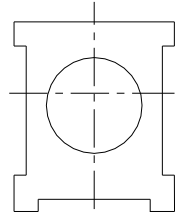
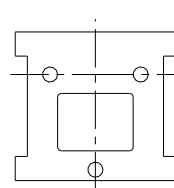
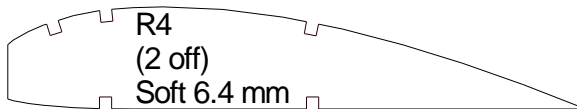
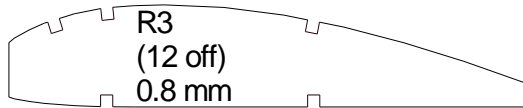
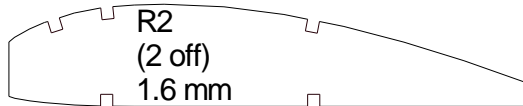
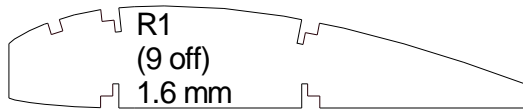
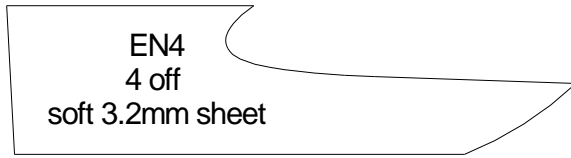

TPR1 (2 off) 3.2mm



TPR2 (2 off 1.6mm)



TPR3 (4 off) 1.6mm

TPR4 (2 off) 6.4mm



TF9 1.6 mm

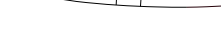

TF8 1.6 mm

TF10

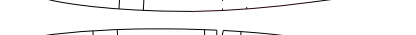

TF7



TF6



TF5



TF4



TF3



SW1 (5 off) 1.6mm

